

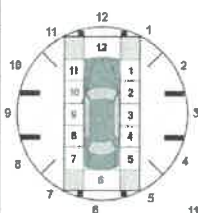

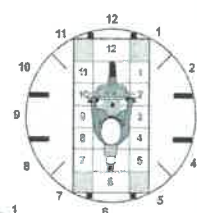
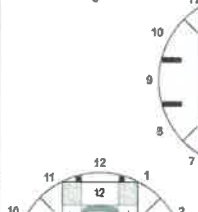
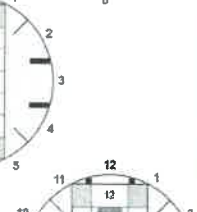
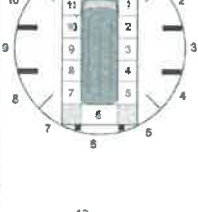
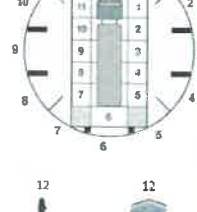
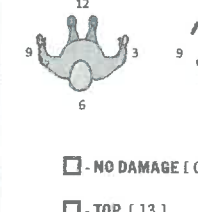

LOCAL REPORT NUMBER*

PAGE 1 OF 5

OWNER	UNIT # 01	OWNER NAME: LAST, FIRST, MIDDLE (<input type="checkbox"/> SAME AS DRIVER)	OWNER PHONE: INCLUDE AREA CODE (<input type="checkbox"/> SAME AS DRIVER)
	OWNER ADDRESS: STREET, CITY, STATE, ZIP (<input type="checkbox"/> SAME AS DRIVER)		
COMMERCIAL CARRIER: NAME, ADDRESS, CITY, STATE, ZIP		COMMERCIAL CARRIER PHONE: INCLUDE AREA CODE	
VEHICLE	LP STATE	LICENSE PLATE #	VEHICLE IDENTIFICATION #
	INSURANCE VERIFIED	INSURANCE COMPANY	INSURANCE POLICY #
	TYPE OF USE <input type="checkbox"/> COMMERCIAL <input type="checkbox"/> GOVERNMENT <input type="checkbox"/> IN EMERGENCY RESPONSE	US DOT #	TOWED BY: COMPANY NAME
	INTERLOCK DEVICE EQUIPPED	HIT/SKIP UNIT	VEHICLE WEIGHT GVWR/GCWR 1 - ≤10K LBS. 2 - 10,001 - 26K LBS. 3 - >26K LBS.
	HAZARDOUS MATERIAL <input type="checkbox"/> MATERIAL RELEASED <input type="checkbox"/> PLACARD CLASS # PLACARD ID #		
	UNIT TYPE 1 - PASSENGER CAR 7 - MOTORCYCLE 2-WHEELED 12 - GOLF CART 18 - LIMO (LIVERY VEHICLE) 23 - PEDESTRIAN / SKATER 2 - PASSENGER VAN (MINIVAN) 8 - MOTORCYCLE 3-WHEELED 13 - SNOWMOBILE 19 - BUS (6+ PASSENGERS) 24 - WHEELCHAIR (ANY TYPE) 3 - SPORT UTILITY VEHICLE 9 - AUTOCYCLE 14 - SINGLE UNIT TRUCK 20 - OTHER VEHICLE 25 - OTHER NON-MOTORIST 4 - PICK UP 10 - MOPED OR MOTORIZED BICYCLE 15 - SEMI-TRACTOR 21 - HEAVY EQUIPMENT 26 - BICYCLE 5 - CARGO VAN 11 - ALL-TERRAIN VEHICLE (ATV / UTV) 16 - FARM EQUIPMENT 22 - ANIMAL WITH RIDER OR ANIMAL-DRAWN VEHICLE 99 - UNKNOWN OR HIT/SKIP 6 - VAN (9-15 SEATS)		
# OF TRAILING UNITS			
WAS VEHICLE OPERATING IN AUTONOMOUS MODE WHEN CRASH OCCURRED? 1 - YES 2 - NO 9 - OTHER / UNKNOWN			
AUTONOMOUS MODE LEVEL 0 - NO AUTOMATION 3 - CONDITIONAL AUTOMATION 9 - UNKNOWN 1 - DRIVER ASSISTANCE 4 - HIGH AUTOMATION 2 - PARTIAL AUTOMATION 5 - FULL AUTOMATION			
SPECIAL FUNCTION 1 - NONE 6 - BUS - CHARTER TOUR 11 - FIRE 16 - FARM 21 - MAIL CARRIER 2 - TAXI 7 - BUS - INTERCITY 12 - MILITARY 17 - MOWING 99 - OTHER / UNKNOWN 3 - ELECTRONIC RIDE SHARING 8 - BUS - SHUTTLE 13 - POLICE 18 - SNOW REMOVAL 4 - SCHOOL TRANSPORT 9 - BUS - OTHER 14 - PUBLIC UTILITY 19 - TOWING 5 - BUS - TRANSIT/COMMUTER 10 - AMBULANCE 15 - CONSTRUCTION EQUIPMENT 20 - SAFETY SERVICE PATROL			
CARGO BODY TYPE 1 - NO CARGO BODY TYPE / NOT APPLICABLE 3 - VEHICLE TOWING ANOTHER MOTOR VEHICLE 5 - INTERMODAL CONTAINER CHASSIS 8 - POLE 12 - CONCRETE MIXER 2 - BUS 4 - LOGGING 6 - CARGO VAN/ENCLOSED BOX 9 - CARGO TANK 13 - AUTO TRANSPORTER 7 - GRAIN/CHIPS/GRAVEL 10 - FLAT BED 14 - GARBAGE/REFUSE 11 - DUMP 99 - OTHER / UNKNOWN			
VEHICLE DEFECTS 1 - TURN SIGNALS 4 - BRAKES 7 - WORN OR SLICK TIRES 9 - MOTOR TROUBLE 99 - OTHER / UNKNOWN 2 - HEAD LAMPS 5 - STEERING 8 - TRAILER EQUIPMENT DEFECTIVE 10 - DISABLED FROM PRIOR ACCIDENT 3 - TAIL LAMPS 6 - TIRE BLOWOUT			
NON-MOTORIST LOCATION AT IMPACT 1 - INTERSECTION - MARKED CROSSWALK 3 - INTERSECTION - OTHER 6 - BICYCLE LANE 9 - MEDIAN/CROSSING ISLAND 12 - FIRST RESPONDER AT INCIDENT SCENE 2 - INTERSECTION - UNMARKED CROSSWALK 4 - MIDBLOCK - MARKED CROSSWALK 7 - SHOULDER / ROADSIDE 10 - DRIVEWAY ACCESS 15 - VEHICLE NOT AT SCENE 5 - TRAVEL LANE - OTHER LOCATION 8 - SIDEWALK 11 - SHARED USE PATHS OR TRAILS 99 - OTHER / UNKNOWN			
ACTION 1 - NON-CONTACT 1 - STRAIGHT AHEAD 7 - MAKING U-TURN 13 - NEGOTIATING A CURVE 18 - APPROACHING OR LEAVING VEHICLE 2 - NON-COLLISION 2 - BACKING 8 - ENTERING TRAFFIC LANE 14 - ENTERING OR CROSSING SPECIFIED LOCATION 19 - STANDING 3 - STRIKING 3 - CHANGING LANES 9 - LEAVING TRAFFIC LANE 15 - WALKING, RUNNING, JOGGING, PLAYING 20 - OTHER NON-MOTORIST 4 - STRUCK PRE-CRASH ACTIONS 4 - OVERTAKING/PASSING 16 - WORKING 21 - STANDING OUTSIDE DISABLED VEHICLE 5 - BOTH STRIKING & STRUCK 5 - MAKING RIGHT TURN 17 - PUSHING VEHICLE 99 - OTHER / UNKNOWN 9 - OTHER / UNKNOWN 6 - MAKING LEFT TURN 12 - DRIVERLESS			
CONTRIBUTING CIRCUMSTANCES 1 - NONE 7 - LEFT OF CENTER 13 - IMPROPER START FROM A PARKED POSITION 17 - VISION OBSTRUCTION 21 - LYING IN ROADWAY 2 - FAILURE TO YIELD 8 - FOLLOWING TOO CLOSE / ACDA 14 - STOPPED OR PARKED ILLEGALLY 18 - OPERATING DEFECTIVE EQUIPMENT 22 - NOT DISCERNIBLE 3 - RAN RED LIGHT 9 - IMPROPER LANE CHANGE 15 - SLOWING OR STOPPED IN TRAFFIC 19 - LOAD SHIFTING/FALLING/SPILLING 23 - OPENING DOOR INTO ROADWAY 4 - RAN STOP SIGN 10 - IMPROPER PASSING 16 - WRONG WAY 20 - IMPROPER CROSSING 99 - OTHER IMPROPER ACTION 5 - UNSAFE SPEED 11 - DROVE OFF ROAD 21 - IMPROPER BACKING 6 - IMPROPER TURN 12 - IMPROPER BACKING			
SEQUENCE OF EVENTS 1 - OVERTURN/ROLLOVER 6 - EQUIPMENT FAILURE 11 - CROSS CENTERLINE - OPPOSITE DIRECTION OF TRAVEL 16 - RAILWAY VEHICLE 22 - WORK ZONE MAINTENANCE EQUIPMENT 2 - FIRE/EXPLOSION 7 - SEPARATION OF UNITS 12 - DOWNHILL RUNAWAY 17 - ANIMAL - FARM 23 - STRUCK BY FALLING, SHIFTING CARGO OR ANYTHING SET IN MOTION BY A MOTOR VEHICLE 3 - IMMERSION 8 - RAN OFF ROAD RIGHT 13 - OTHER NON-COLLISION 18 - ANIMAL - DEER 24 - OTHER MOVABLE OBJECT 4 - JACKKNIFE 9 - RAN OFF ROAD LEFT 14 - PEDESTRIAN 19 - ANIMAL - OTHER 20 - MOTOR VEHICLE IN TRANSPORT 5 - CARGO / EQUIPMENT LOSS OR SHIFT 10 - CROSS MEDIAN 15 - PEDAL CYCLE 21 - PARKED MOTOR VEHICLE			
COLLISION WITH FIXED OBJECT - STRUCK 25 - IMPACT ATTENUATOR / CRASH CUSHION 31 - GUARDRAIL END 37 - TRAFFIC SIGN POST 43 - CURB 50 - WORK ZONE MAINTENANCE EQUIPMENT 26 - BRIDGE OVERHEAD STRUCTURE 32 - PORTABLE BARRIER 38 - OVERHEAD SIGN POST 44 - DITCH 51 - WALL 27 - BRIDGE PIER OR ABUTMENT 33 - MEDIAN CABLE BARRIER 39 - LIGHT / LUMINARIES SUPPORT 45 - EMBANKMENT 52 - BUILDING 28 - BRIDGE PARAPET 34 - MEDIAN GUARDRAIL BARRIER 40 - UTILITY POLE 46 - FENCE 53 - TUNNEL 29 - BRIDGE RAIL 35 - MEDIAN CONCRETE BARRIER 41 - OTHER POST, POLE OR SUPPORT 47 - MAILBOX 54 - OTHER FIXED OBJECT 30 - GUARDRAIL FACE 36 - MEDIAN OTHER BARRIER 42 - CULVERT 48 - TREE 99 - OTHER / UNKNOWN 49 - FIRE HYDRANT			
FIRST HARMFUL EVENT 1 MOST HARMFUL EVENT			

LOCAL REPORT NUMBER 2025-00006280	
DAMAGE DAMAGE SCALE 9 1 - NONE 3 - FUNCTIONAL DAMAGE 2 - MINOR DAMAGE 4 - DISABLING DAMAGE 9 - UNKNOWN	
DAMAGED AREA(S) INDICATE ALL THAT APPLY         <input type="checkbox"/> - NO DAMAGE [0] <input type="checkbox"/> - UNDERCARRIAGE [14] <input type="checkbox"/> - TOP [13] <input type="checkbox"/> - ALL AREAS [15] <input checked="" type="checkbox"/> - UNIT NOT AT SCENE [16]	
INITIAL POINT OF CONTACT 0 - NO DAMAGE 14 - UNDERCARRIAGE 9 9 1-12 - REFER TO UNIT DIAGRAM 15 - VEHICLE NOT AT SCENE 13 - TOP 99 - UNKNOWN	
TRAFFIC TRAFFICWAY FLOW 2 1 - ONE-WAY 2 - TWO-WAY # OF THROUGH LANES ON ROAD 2 TRAFFIC CONTROL 6 1 - ROUNDABOUT 4 - STOP SIGN 2 - SIGNAL 5 - YIELD SIGN 3 - FLASHER 6 - NO CONTROL	
UNIT / NON-MOTORIST DIRECTION FROM 9 TO 9 1 - NORTH 5 - NORTHEAST 2 - SOUTH 6 - NORTHWEST 3 - EAST 7 - SOUTHEAST 4 - WEST 8 - SOUTHWEST 9 - OTHER / UNKNOWN	
UNIT SPEED POSTED SPEED DETECTED SPEED 3 1 - STATED / ESTIMATED SPEED 2 - CALCULATED / EDR 3 - UNDETERMINED	

OWNER	UNIT # 02	OWNER NAME: LAST, FIRST, MIDDLE (☐ SAME AS DRIVER) COPPOCK, CIERRA JORDYN	OWNER PHONE: INCLUDE AREA CODE ☐ SAME AS DRIVER 9376893169
	OWNER ADDRESS: STREET, CITY, STATE, ZIP ☐ SAME AS DRIVER 4453 STONECASTLE DR Drive BEAVERCREEK, OH 45440		
COMMERCIAL CARRIER: NAME, ADDRESS, CITY, STATE, ZIP		COMMERCIAL CARRIER PHONE: INCLUDE AREA CODE	
LP STATE OH	LICENSE PLATE # JLZ3796	VEHICLE IDENTIFICATION # 1G1PE5SB8G7218631	VEHICLE YEAR 2016
INSURANCE VERIFIED	INSURANCE COMPANY Progressive	INSURANCE POLICY # 951115209	VEHICLE MAKE Chevrolet
TYPE OF USE <input type="checkbox"/> COMMERCIAL <input type="checkbox"/> GOVERNMENT <input type="checkbox"/> IN EMERGENCY RESPONSE	US DOT #	COLOR CRM	VEHICLE MODEL Cruze
INTERLOCK DEVICE EQUIPPED	HIT/SKIP UNIT <input type="checkbox"/>	#OCCUPANTS 00	VEHICLE WEIGHT GVWR/GCWR 1 - ≤10K LBS. 2 - 10,001 - 26K LBS. 3 - >26K LBS.
HAZARDOUS MATERIAL <input type="checkbox"/> MATERIAL RELEASED <input type="checkbox"/> PLACARD CLASS # PLACARD ID #			
TOWED BY: COMPANY NAME			
UNIT TYPE 01 1 - PASSENGER CAR 7 - MOTORCYCLE 2-WHEELED 12 - GOLF CART 18 - LIMO (LIVERY VEHICLE) 23 - PEDESTRIAN / SKATER 2 - PASSENGER VAN (MINIVAN) 8 - MOTORCYCLE 3-WHEELED 13 - SNOWMOBILE 19 - BUS (6+ PASSENGERS) 24 - WHEELCHAIR (ANY TYPE) 3 - SPORT UTILITY VEHICLE 9 - AUTOCYCLE 14 - SINGLE UNIT TRUCK 20 - OTHER VEHICLE 25 - OTHER NON-MOTORIST 4 - PICK UP 10 - MOPED OR MOTORIZED BICYCLE 15 - SEMI-TRACTOR 21 - HEAVY EQUIPMENT 26 - BICYCLE 5 - CARGO VAN 11 - ALL TERRAIN VEHICLE (ATV / UTV) 16 - FARM EQUIPMENT 22 - ANIMAL WITH RIDER OR ANIMAL-DRAWN VEHICLE 27 - TRAIN 6 - VAN (9-15 SEATS) 17 - MOTORHOME 99 - UNKNOWN OR HIT/SKIP			
# OF TRAILING UNITS 00			
WAS VEHICLE OPERATING IN AUTONOMOUS MODE WHEN CRASH OCCURRED? 2 1 - YES 2 - NO 9 - OTHER / UNKNOWN			
AUTONOMOUS MODE LEVEL 0 0 - NO AUTOMATION 1 - DRIVER ASSISTANCE 3 - CONDITIONAL AUTOMATION 9 - UNKNOWN 2 - PARTIAL AUTOMATION 4 - HIGH AUTOMATION 5 - FULL AUTOMATION			
SPECIAL FUNCTION 01 1 - NONE 6 - BUS - CHARTER TOUR 11 - FIRE 16 - FARM 21 - MAIL CARRIER 2 - TAXI 7 - BUS - INTERCITY 12 - MILITARY 17 - MOWING 99 - OTHER / UNKNOWN 3 - ELECTRONIC RIDE SHARING 8 - BUS - SHUTTLE 13 - POLICE 18 - SNOW REMOVAL 4 - SCHOOL TRANSPORT 9 - BUS - OTHER 14 - PUBLIC UTILITY 19 - TOWING 5 - BUS - TRANSIT/COMMUTER 10 - AMBULANCE 15 - CONSTRUCTION EQUIPMENT 20 - SAFETY SERVICE PATROL			
CARGO BODY TYPE 01 1 - NO CARGO BODY TYPE / NOT APPLICABLE 3 - VEHICLE TOWING ANOTHER MOTOR VEHICLE 5 - INTERMODAL CONTAINER CHASSIS 8 - POLE 12 - CONCRETE MIXER 2 - BUS 4 - LOGGING 6 - CARGO VAN/ENCLOSED BOX 9 - CARGO TANK 13 - AUTOTRANSPORTER 7 - GRAIN/CHIPS/GRAVEL 10 - FLAT BED 14 - GARBAGE/REFUSE 99 - OTHER / UNKNOWN			
VEHICLE DEFECTS 01 1 - TURN SIGNALS 4 - BRAKES 7 - WORN OR SLICK TIRES 9 - MOTOR TROUBLE 99 - OTHER / UNKNOWN 2 - HEAD LAMPS 5 - STEERING 8 - TRAILER EQUIPMENT DEFECTIVE 10 - DISABLED FROM PRIOR ACCIDENT 3 - TAIL LAMPS 6 - TIRE BLOWOUT			
NON-MOTORIST LOCATION AT IMPACT 99 1 - INTERSECTION - MARKED CROSSWALK 3 - INTERSECTION - OTHER 6 - BICYCLE LANE 9 - MEDIAN/CROSSING ISLAND 12 - FIRST RESPONDER AT INCIDENT SCENE 2 - INTERSECTION - UNMARKED CROSSWALK 4 - MIDBLOCK - MARKED CROSSWALK 7 - SHOULDER / ROADSIDE 10 - DRIVEWAY ACCESS 21 - STANDING OUTSIDE DISABLED VEHICLE 5 - TRAVEL LANE - OTHER LOCATION 8 - SIDEWALK 11 - SHARED USE PATHS OR TRAILS 99 - OTHER / UNKNOWN			
ACTION 4 1 - NON-CONTACT 1 - STRAIGHT AHEAD 7 - MAKING U-TURN 13 - NEGOTIATING A CURVE 18 - APPROACHING OR LEAVING VEHICLE 2 - NON-COLLISION 2 - BACKING 8 - ENTERING TRAFFIC LANE 14 - ENTERING OR CROSSING SPECIFIED LOCATION 19 - STANDING 3 - STRIKING 3 - CHANGING LANES 9 - LEAVING TRAFFIC LANE 15 - WALKING, RUNNING, JOGGING, PLAYING 20 - OTHER NON-MOTORIST 4 - STRUCK PRE-CRASH ACTIONS 4 - OVERTAKING/PASSING 10 - PARKED 11 - SLOWING OR STOPPED IN TRAFFIC 16 - WORKING 21 - STANDING OUTSIDE DISABLED VEHICLE 5 - BOTH STRIKING & STRUCK 5 - MAKING RIGHT TURN 11 - SLOWING OR STOPPED IN TRAFFIC 17 - PUSHING VEHICLE 99 - OTHER / UNKNOWN 9 - OTHER / UNKNOWN 6 - MAKING LEFT TURN 12 - DRIVERLESS			
CONTRIBUTING CIRCUMSTANCES 01 1 - NONE 7 - LEFT OF CENTER 13 - IMPROPER START FROM A PARKED POSITION 17 - VISION OBSTRUCTION 21 - LYING IN ROADWAY 2 - FAILURE TO YIELD 8 - FOLLOWING TOO CLOSE / ACDA 14 - STOPPED OR PARKED ILLEGALLY 18 - OPERATING DEFECTIVE EQUIPMENT 22 - NOT DISCERNIBLE 3 - RAN RED LIGHT 9 - IMPROPER LANE CHANGE 15 - SWERVING TO AVOID 19 - LOAD SHIFTING/FALLING/SPILLING 23 - OPENING DOOR INTO ROADWAY 4 - RAN STOP SIGN 10 - IMPROPER PASSING 16 - WRONG WAY 20 - IMPROPER CROSSING 99 - OTHER IMPROPER ACTION 5 - UNSAFE SPEED 11 - DROVE OFF ROAD 21 - LIVING IN ROADWAY 6 - IMPROPER TURN 12 - IMPROPER BACKING			
SEQUENCE OF EVENTS 1 1 - OVERTURN/ROLLOVER 6 - EQUIPMENT FAILURE 11 - CROSS CENTERLINE - OPPOSITE DIRECTION OF TRAVEL 16 - RAILWAY VEHICLE 22 - WORK ZONE MAINTENANCE EQUIPMENT 2 - FIRE/EXPLOSION 7 - SEPARATION OF UNITS 12 - DOWNHILL RUNAWAY 17 - ANIMAL - FARM 23 - STRUCK BY FALLING, SHIFTING CARGO OR ANYTHING SET IN MOTION BY A MOTOR VEHICLE 3 - IMMERSION 8 - RAN OFF ROAD RIGHT 13 - OTHER NON-COLLISION 18 - ANIMAL - DEER 24 - OTHER MOVABLE OBJECT 4 - JACKKNIFE 9 - RAN OFF ROAD LEFT 14 - PEDESTRIAN 19 - ANIMAL - OTHER 25 - OTHER 5 - CARGO / EQUIPMENT LOSS OR SHIFT 10 - CROSS MEDIAN 15 - PEDALCYCLE 20 - MOTOR VEHICLE IN TRANSPORT			
COLLISION WITH FIXED OBJECT - STRUCK 1 25 - IMPACT ATTENUATOR / CRASH CUSHION 31 - GUARDRAIL END 37 - TRAFFIC SIGN POST 43 - CURB 50 - WORK ZONE MAINTENANCE EQUIPMENT 26 - BRIDGE OVERHEAD STRUCTURE 32 - PORTABLE BARRIER 38 - OVERHEAD SIGN POST 44 - DITCH 51 - WALL 27 - BRIDGE PIER OR ABUTMENT 33 - MEDIAN CABLE BARRIER 39 - LIGHT / LUMINARIES SUPPORT 45 - EMBANKMENT 52 - BUILDING 28 - BRIDGE PARAPET 34 - MEDIAN GUARDRAIL BARRIER 40 - UTILITY POLE 46 - FENCE 53 - TUNNEL 29 - BRIDGE RAIL 35 - MEDIAN CONCRETE BARRIER 41 - OTHER POST, POLE OR SUPPORT 47 - MAILBOX 54 - OTHER FIXED OBJECT 30 - GUARDRAIL FACE 36 - MEDIAN OTHER BARRIER 42 - CULVERT 48 - TREE 99 - OTHER / UNKNOWN			
FIRST HARMFUL EVENT 1 MOST HARMFUL EVENT 1			

LOCAL REPORT NUMBER 2025-00006280	
DAMAGE DAMAGE SCALE 2 1 - NONE 3 - FUNCTIONAL DAMAGE 2 - MINOR DAMAGE 4 - DISABLING DAMAGE 9 - UNKNOWN	
DAMAGED AREA(S) INDICATE ALL THAT APPLY	
<input type="checkbox"/> NO DAMAGE [0] <input type="checkbox"/> UNDERCARRIAGE [14] <input type="checkbox"/> TOP [13] <input type="checkbox"/> ALL AREAS [15] <input type="checkbox"/> UNIT NOT AT SCENE [16]	
INITIAL POINT OF CONTACT 05 0 - NO DAMAGE 14 - UNDERCARRIAGE 1-12 - REFER TO UNIT DIAGRAM 15 - VEHICLE NOT AT SCENE 13 - TOP 99 - UNKNOWN	
TRAFFIC TRAFFICWAY FLOW 2 1 - ONE-WAY 2 - TWO-WAY TRAFFIC CONTROL 6 1 - ROUNDABOUT 4 - STOP SIGN 2 - SIGNAL 5 - YIELD SIGN 3 - FLASHER 6 - NO CONTROL	
# OF THROUGH LANES ON ROAD 2	RAIL GRADE CROSSING 1 1 - NOT INVOLVED 2 - INVOLVED-ACTIVE CROSSING 3 - INVOLVED-PASSIVE CROSSING
UNIT / NON-MOTORIST DIRECTION FROM 5 TO 8 1 - NORTH 5 - NORTHEAST 2 - SOUTH 6 - NORTHWEST 3 - EAST 7 - SOUTHEAST 4 - WEST 8 - SOUTHWEST 9 - OTHER / UNKNOWN	
UNIT SPEED 0	DETECTED SPEED 1 1 - STATED / ESTIMATED SPEED 2 - CALCULATED / EOR 3 - UNDETERMINED
POSTED SPEED 0	



MOTORIST / Non-MOTORIST

LOCAL REPORT NUMBER

2025-00006280

UNIT # 01		NAME: LAST, FIRST, MIDDLE		DATE OF BIRTH		AGE	GENDER		
ADDRESS: STREET, CITY, STATE, ZIP				CONTACT PHONE - INCLUDE AREA CODE					
INJURIES 5	INJURED TAKEN BY	EMS AGENCY (NAME)	INJURED TAKEN TO: MEDICAL FACILITY (NAME, CITY)	SAFETY EQUIPMENT USED 99	<input type="checkbox"/> DOT-COMPLIANT MC HELMET	SEATING POSITION 99	AIR BAG USAGE 6	EJECTION 1	TRAPPED 1
OL STATE	OPERATOR LICENSE NUMBER		OFFENSE CHARGED	LOCAL CODE <input type="checkbox"/>	OFFENSE DESCRIPTION		CITATION NUMBER		
OL CLASS	ENDORSEMENT SELECT UP TO 2	RESTRICTION SELECT UP TO 3	DRIVER DISTRACTED BY 9	ALCOHOL / DRUG SUSPECTED <input type="checkbox"/> ALCOHOL <input type="checkbox"/> MARIJUANA <input type="checkbox"/> OTHER DRUG		CONDITION 9	ALCOHOL TEST STATUS TYPE VALUE 1 1		DRUG TEST(S) STATUS TYPE RESULT SELECT UP TO 4 1 1

UNIT # 02		NAME: LAST, FIRST, MIDDLE COPPOCK, CIERRA JORDYN		DATE OF BIRTH 12101999		AGE 25	GENDER F		
ADDRESS: STREET, CITY, STATE, ZIP 4453 STONECASTLE DR Drive BEAVERCREEK, OH 45440				CONTACT PHONE - INCLUDE AREA CODE 9376893169					
INJURIES 5	INJURED TAKEN BY	EMS AGENCY (NAME)	INJURED TAKEN TO: MEDICAL FACILITY (NAME, CITY)	SAFETY EQUIPMENT USED 01	<input type="checkbox"/> DOT-COMPLIANT MC HELMET	SEATING POSITION 99	AIR BAG USAGE 1	EJECTION 1	TRAPPED 1
OL STATE	OPERATOR LICENSE NUMBER		OFFENSE CHARGED	LOCAL CODE <input type="checkbox"/>	OFFENSE DESCRIPTION		CITATION NUMBER		
OL CLASS	ENDORSEMENT SELECT UP TO 2	RESTRICTION SELECT UP TO 3	DRIVER DISTRACTED BY 1	ALCOHOL / DRUG SUSPECTED <input type="checkbox"/> ALCOHOL <input type="checkbox"/> MARIJUANA <input type="checkbox"/> OTHER DRUG		CONDITION 9	ALCOHOL TEST STATUS TYPE VALUE 1 1		DRUG TEST(S) STATUS TYPE RESULT SELECT UP TO 4 1 1

UNIT #		NAME: LAST, FIRST, MIDDLE		DATE OF BIRTH		AGE	GENDER		
ADDRESS: STREET, CITY, STATE, ZIP				CONTACT PHONE - INCLUDE AREA CODE					
INJURIES	INJURED TAKEN BY	EMS AGENCY (NAME)	INJURED TAKEN TO: MEDICAL FACILITY (NAME, CITY)	SAFETY EQUIPMENT USED	<input type="checkbox"/> DOT-COMPLIANT MC HELMET	SEATING POSITION	AIR BAG USAGE	EJECTION	TRAPPED
OL STATE	OPERATOR LICENSE NUMBER		OFFENSE CHARGED	LOCAL CODE	OFFENSE DESCRIPTION		CITATION NUMBER		
OL CLASS	ENDORSEMENT SELECT UP TO 2	RESTRICTION SELECT UP TO 3	DRIVER DISTRACTED BY	ALCOHOL / DRUG SUSPECTED <input type="checkbox"/> ALCOHOL <input type="checkbox"/> MARIJUANA <input type="checkbox"/> OTHER DRUG		CONDITION	ALCOHOL TEST STATUS TYPE VALUE		DRUG TEST(S) STATUS TYPE RESULT SELECT UP TO 4

INJURIES	SEATING POSITION	AIR BAG	OL CLASS	OL RESTRICTION(S)	DRIVER DISTRACTION	TEST STATUS
1 - FATAL	1 - FRONT - LEFT SIDE (MOTORCYCLE DRIVER)	1 - NOT DEPLOYED	1 - CLASS A	1 - ALCOHOL INTERLOCK DEVICE	1 - NOT DISTRACTED	1 - NONE GIVEN
2 - SUSPECTED SERIOUS INJURY	2 - FRONT - MIDDLE	2 - DEPLOYED FRONT	2 - CLASS B	2 - CDL INTRASTATE ONLY	2 - MANUALLY OPERATING AN ELECTRONIC COMMUNICATION DEVICE (TEXTING, TYPING, DIALING)	2 - TEST REFUSED
3 - SUSPECTED MINOR INJURY	3 - FRONT - RIGHT SIDE	3 - DEPLOYED SIDE	3 - CLASS C	3 - CORRECTIVE LENSES	3 - TALKING ON HANDS-FREE COMMUNICATION DEVICE	3 - TEST GIVEN, CONTAMINATED SAMPLE / UNUSABLE
4 - POSSIBLE INJURY	4 - SECOND - LEFT SIDE (MOTORCYCLE PASSENGER)	4 - DEPLOYED BOTH FRONT / SIDE	4 - REGULAR CLASS (OHIO = D)	4 - FARM WAIVER	4 - TALKING ON HAND-HELD COMMUNICATION DEVICE	4 - TEST GIVEN, RESULTS KNOWN
5 - NO APPARENT INJURY	5 - SECOND - MIDDLE	5 - NOT APPLICABLE	5 - MC MOPED ONLY	5 - EXCEPT CLASS A BUS	5 - OTHER ACTIVITY WITH AN ELECTRONIC DEVICE	5 - TEST GIVEN, RESULTS UNKNOWN
INJURED TAKEN BY	6 - SECOND - RIGHT SIDE	9 - DEPLOYMENT UNKNOWN	6 - NO VALID OL	6 - EXCEPT CLASS A & CLASS B BUS	6 - PASSENGER	ALCOHOL TEST TYPE
1 - NOT TRANSPORTED / TREATED AT SCENE	7 - THIRD - LEFT SIDE (MOTORCYCLE SIDE CAR)	EJECTION	OL ENDORSEMENT	7 - EXCEPT TRACTOR-TRAILER	7 - OTHER DISTRACTION INSIDE THE VEHICLE	1 - NONE
2 - EMS	8 - THIRD - MIDDLE	1 - NOT EJECTED	H - HAZMAT	8 - INTERMEDIATE LICENSE RESTRICTIONS	8 - OTHER DISTRACTION OUTSIDE THE VEHICLE	2 - BLOOD
3 - POLICE	9 - THIRD - RIGHT SIDE	2 - PARTIALLY EJECTED	M - MOTORCYCLE	9 - LEARNER'S PERMIT RESTRICTIONS	9 - OTHER / UNKNOWN	3 - URINE
9 - OTHER / UNKNOWN	10 - SLEEPER SECTION OF TRUCK CAB	3 - TOTALLY EJECTED	P - PASSENGER	10 - LIMITED TO DAYLIGHT ONLY	CONDITION	4 - BREATH
SAFETY EQUIPMENT	11 - PASSENGER IN OTHER ENCLOSED CARGO AREA (NON-TRAILING UNIT, BUS, PICK-UP WITH CAP)	4 - NOT APPLICABLE	N - TANKER	11 - LIMITED TO EMPLOYMENT	1 - APPARENTLY NORMAL	5 - OTHER
1 - NONE USED	12 - PASSENGER IN UNENCLOSED CARGO AREA	TRAPPED	Q - MOTOR SCOOTER	12 - LIMITED - OTHER	2 - PHYSICAL IMPAIRMENT	DRUG TEST TYPE
2 - SHOULDER BELT ONLY USED	13 - TRAILING UNIT	1 - NOT TRAPPED	R - THREE-WHEEL MOTORCYCLE	13 - MECHANICAL DEVICES (SPECIAL BRAKES, HAND CONTROLS, OR OTHER ADAPTIVE DEVICES)	3 - EMOTIONAL (E.G., DEPRESSED, ANGRY, DISTURBED)	1 - NONE
3 - LAP BELT ONLY USED	14 - RIDING ON VEHICLE EXTERIOR (NON-TRAILING UNIT)	2 - EXTRICATED BY MECHANICAL MEANS	S - SCHOOL BUS	14 - MILITARY VEHICLES ONLY	4 - ILLNESS	2 - BLOOD
4 - SHOULDER & LAP BELT USED	15 - NON-MOTORIST	3 - FREED BY NON-MECHANICAL MEANS	T - DOUBLE & TRIPLE TRAILERS	15 - MOTOR VEHICLES WITHOUT AIR BRAKES	5 - FELL ASLEEP, FAINTED, FATIGUED, ETC.	3 - URINE
5 - CHILD RESTRAINT SYSTEM - FORWARD FACING	99 - OTHER / UNKNOWN	GENDER	X - TANKER / HAZMAT	16 - OUTSIDE MIRROR	6 - UNDER THE INFLUENCE OF MEDICATIONS / DRUGS / ALCOHOL	4 - OTHER
6 - CHILD RESTRAINT SYSTEM - REAR FACING		F - FEMALE		17 - PROSTHETIC AID	9 - OTHER / UNKNOWN	DRUG TEST RESULT(S)
7 - BOOSTER SEAT		M - MALE		18 - OTHER		1 - AMPHETAMINES
8 - HELMET USED		U - OTHER / UNKNOWN				2 - BARBITURATES
9 - PROTECTIVE PADS USED (ELBOW, KNEES, ETC.)						3 - BENZODIAZEPINES
10 - REFLECTIVE CLOTHING						4 - CANNABINOIDS
11 - LIGHTING - PEDESTRIAN / BICYCLE ONLY						5 - COCAINE
99 - OTHER / UNKNOWN						6 - OPIATES / OPIOIDS
						7 - OTHER
						8 - NEGATIVE RESULTS



OCCUPANT / WITNESS ADDENDUM

LOCAL REPORT NUMBER

2025-00006280

UNIT #	NAME: LAST, FIRST, MIDDLE	DATE OF BIRTH	AGE	GENDER					
01	UNKNOWN,								
ADDRESS: STREET, CITY, STATE, ZIP		CONTACT PHONE - INCLUDE AREA CODE							
INJURIES	INJURED TAKEN BY	EMS AGENCY (NAME)	INJURED TAKEN TO: MEDICAL FACILITY (NAME, CITY)	SAFETY EQUIPMENT USED	<input type="checkbox"/> DOT-COMPLIANT MC HELMET	SEATING POSITION	AIR BAG USAGE	EJECTION	TRAPPED
5	1			9, 9		9, 9	9	1	1
UNIT #	NAME: LAST, FIRST, MIDDLE	DATE OF BIRTH	AGE	GENDER					
ADDRESS: STREET, CITY, STATE, ZIP		CONTACT PHONE - INCLUDE AREA CODE							
INJURIES	INJURED TAKEN BY	EMS AGENCY (NAME)	INJURED TAKEN TO: MEDICAL FACILITY (NAME, CITY)	SAFETY EQUIPMENT USED	<input type="checkbox"/> DOT-COMPLIANT MC HELMET	SEATING POSITION	AIR BAG USAGE	EJECTION	TRAPPED
UNIT #	NAME: LAST, FIRST, MIDDLE	DATE OF BIRTH	AGE	GENDER					
ADDRESS: STREET, CITY, STATE, ZIP		CONTACT PHONE - INCLUDE AREA CODE							
INJURIES	INJURED TAKEN BY	EMS AGENCY (NAME)	INJURED TAKEN TO: MEDICAL FACILITY (NAME, CITY)	SAFETY EQUIPMENT USED	<input type="checkbox"/> DOT-COMPLIANT MC HELMET	SEATING POSITION	AIR BAG USAGE	EJECTION	TRAPPED
UNIT #	NAME: LAST, FIRST, MIDDLE	DATE OF BIRTH	AGE	GENDER					
ADDRESS: STREET, CITY, STATE, ZIP		CONTACT PHONE - INCLUDE AREA CODE							
INJURIES	INJURED TAKEN BY	EMS AGENCY (NAME)	INJURED TAKEN TO: MEDICAL FACILITY (NAME, CITY)	SAFETY EQUIPMENT USED	<input type="checkbox"/> DOT-COMPLIANT MC HELMET	SEATING POSITION	AIR BAG USAGE	EJECTION	TRAPPED
INJURIES		SAFETY EQUIPMENT USED		SEATING POSITION		AIR BAG USAGE			
1 - FATAL		1 - NONE USED - VEHICLE OCCUPANT		1 - FRONT - LEFT SIDE (MOTORCYCLE DRIVER)		1 - NOT DEPLOYED			
2 - SUSPECTED SERIOUS INJURY		2 - SHOULDER BELT ONLY USED		2 - FRONT - MIDDLE		2 - DEPLOYED FRONT			
3 - SUSPECTED MINOR INJURY		3 - LAP BELT ONLY USED		3 - FRONT - RIGHT SIDE		3 - DEPLOYED SIDE			
4 - POSSIBLE INJURY		4 - SHOULDER & LAP BELT USED		4 - SECOND - LEFT SIDE (MOTORCYCLE PASSENGER)		4 - DEPLOYED BOTH FRONT/SIDE			
5 - NO APPARENT INJURY		5 - CHILD RESTRAINT SYSTEM - FORWARD FACING		5 - SECOND - MIDDLE		5 - NOT APPLICABLE			
INJURED TAKEN BY		6 - CHILD RESTRAINT SYSTEM - REAR FACING		6 - SECOND - RIGHT SIDE		9 - DEPLOYMENT UNKNOWN			
1 - NOT TRANSPORTED / TREATED AT SCENE		7 - BOOSTER SEAT		7 - THIRD - LEFT SIDE (MOTORCYCLE SIDE CAR)		EJECTION			
2 - EMS		8 - HELMET USED		8 - THIRD - MIDDLE		1 - NOT EJECTED			
3 - POLICE		9 - PROTECTIVE PADS USED (ELBOW, KNEES, ETC.)		9 - THIRD - RIGHT SIDE		2 - PARTIALLY EJECTED			
9 - OTHER / UNKNOWN		10 - REFLECTIVE CLOTHING		10 - SLEEPER SECTION OF TRUCK CAB		3 - TOTALLY EJECTED			
GENDER		11 - LIGHTING - PEDESTRIAN / BICYCLE ONLY		11 - PASSENGER IN OTHER ENCLOSED CARGO AREA (NON-TRAILING UNIT, BUS, PICK-UP WITH CAP)		4 - NOT APPLICABLE			
F - FEMALE		99 - OTHER / UNKNOWN		12 - PASSENGER IN UNENCLOSED CARGO AREA		TRAPPED			
M - MALE				13 - TRAILING UNIT		1 - NOT TRAPPED			
U - OTHER / UNKNOWN				14 - RIDING ON VEHICLE EXTERIOR (NON-TRAILING UNIT)		2 - EXTRICATED BY MECHANICAL MEANS			
				15 - NON-MOTORIST		3 - FREED BY NON-MECHANICAL MEANS			
				99 - OTHER / UNKNOWN					
NAME: LAST, FIRST, MIDDLE		DATE OF BIRTH		AGE	GENDER				
ADDRESS: STREET, CITY, STATE, ZIP		CONTACT PHONE - INCLUDE AREA CODE							
NAME: LAST, FIRST, MIDDLE		DATE OF BIRTH		AGE	GENDER				
ADDRESS: STREET, CITY, STATE, ZIP		CONTACT PHONE - INCLUDE AREA CODE							
NAME: LAST, FIRST, MIDDLE		DATE OF BIRTH		AGE	GENDER				
ADDRESS: STREET, CITY, STATE, ZIP		CONTACT PHONE - INCLUDE AREA CODE							

OHIO TRAFFIC ACCIDENT — DIAGRAM/NARRATIVE CONTINUATION

OH-2 (Rev. 1/82)

LOCAL REPORT NUMBER 2025-00006280	REPORTING AGENCY Bellbrook Police	DATE OF ACCIDENT M 07 D 11 Y 2025
IN COUNTY OF 29 Greene	ACCIDENT LOCATION LITTLE SUGARCREEK RD Road	
<p>On 7/11/2025 at 1703 hours I was dispatched to my PD for a reported hit/skip crash. I spoke with registered owner Sierra Coppock who stated her vehicle was struck while parked at Magee Park at around 1530 hours. Ms. Coppock stated she was near the creek with her family and heard and impact. When she returned to her vehicle, the right side had minor damage to the back quarter panel, front door and front quarter panel. She stated the damage to the front right corner was earlier damage. She then returned home in Beavercreek before coming to report it.</p> <p>I followed up at Magee Park to see if there were any witnesses. A majority of the people there had recently arrived for a party and were not there at the stated time of the incident. I spoke to another couple on the south side of the parking lot, they also stated they recently arrived and were not there at the time of the incident. I was not able to locate anyone who had witnessed the incident.</p> <p>I did observe some tire marks in the grass just beyond the parking spots Ms. Coppock stated she was parked in, however I was unable to determine if they were made earlier that day or previously, and if they were from vehicle tires or from mowers.</p>		
OFFICERS SIGNATURE BB50\ Moore, Karen, ,		BADGE NO. BB50

HSY 7002

OHIO TRAFFIC ACCIDENT — DIAGRAM/NARRATIVE CONTINUATION

OH-2 (Rev. 1/82)

LOCAL REPORT NUMBER 2025-00006280	REPORTING AGENCY Bellbrook Police	DATE OF ACCIDENT M 07 D 11 Y 2025
IN COUNTY OF 29 Greene	ACCIDENT LOCATION LITTLE SUGARCREEK RD Road	

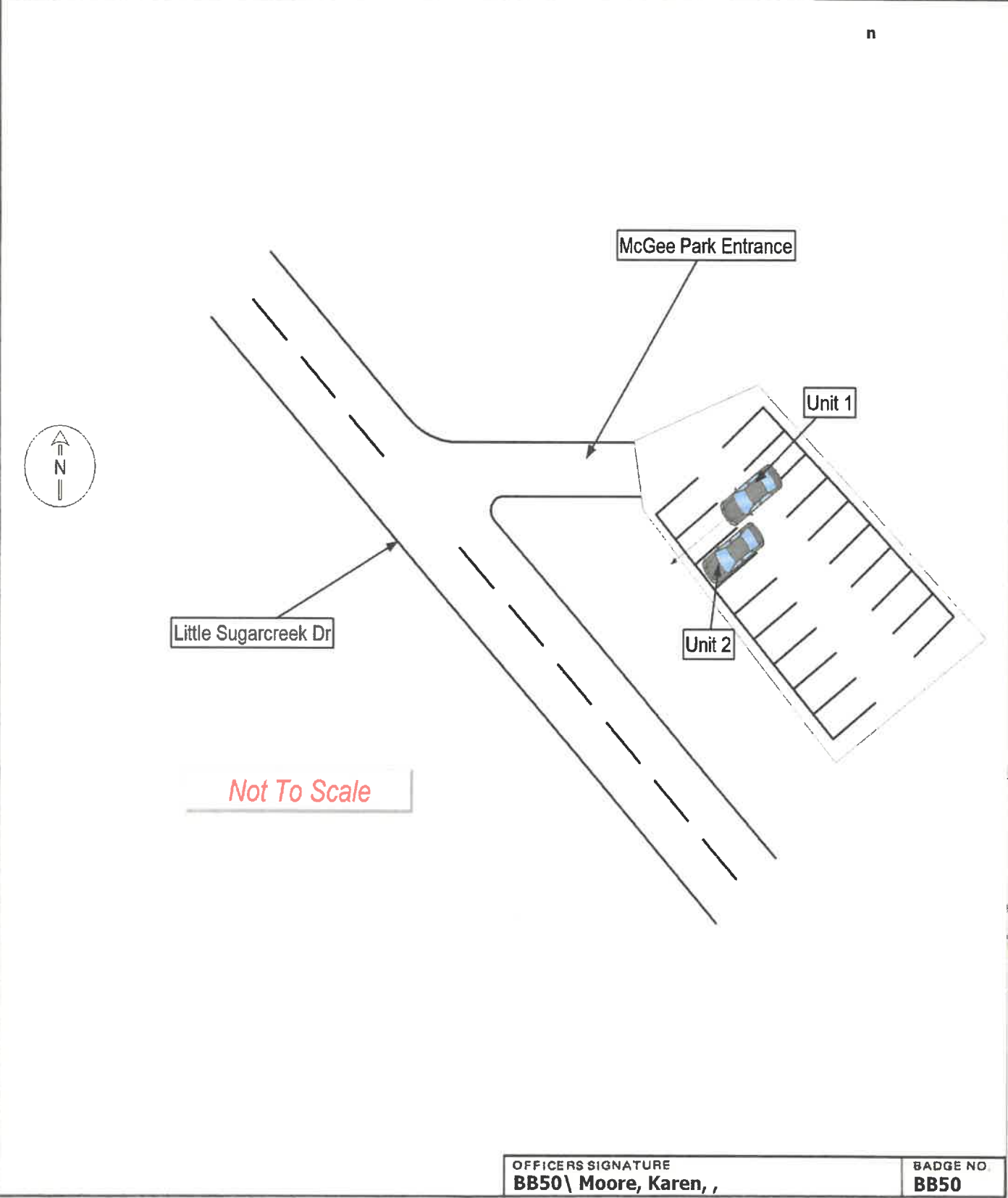

OFFICERS SIGNATURE BB50\ Moore, Karen, ,	BADGE NO. BB50
--	--------------------------

LOCAL REPORT NUMBER 25-6280	REPORTING AGENCY Bellbrook PD	DATE OF CRASH M 7 D 11 Y 25
--------------------------------	----------------------------------	--------------------------------

FOR LOCAL USE ONLY - DO NOT SUBMIT TO THE STATE EXCEPT FOR FATAL CRASHES

I, <u>Cierra Coppack</u> PRINTED	HEREBY MAKE THIS VOLUNTARY STATEMENT TO
<u>K. Moore</u> OFFICER'S NAME	AT <u>Magee Park</u> LOCATION
<p>my child, myself & two other people were down at the creek at Magee Park. We all heard tires screeching & what sounded like a car accident or someone hitting another car. When one of us that went up to investigate, we saw nothing out of the ordinary. We decided to leave & approach my car, the passenger side door couldn't open. That is when we saw someone hit my car. There was no note left behind my partner who was there went up to ask people at the actual playground area if they saw anything. All they said was they were unsure what happened or they didn't see what happened. We left at 4:00 pm, heard sound at 3:28 pm</p> <p>Insurance policy: 95115209 agent #: 1-937-298-4440</p>	
4453 Stone castle Dr Bensenville OH apt 1102 zip 44540 45440	
ADDRESS OF WITNESS X	OFFICER'S SIGNATURE X <u>K. Moore #50</u>
SIGNATURE OF WITNESS X <u>[Signature]</u>	